

X

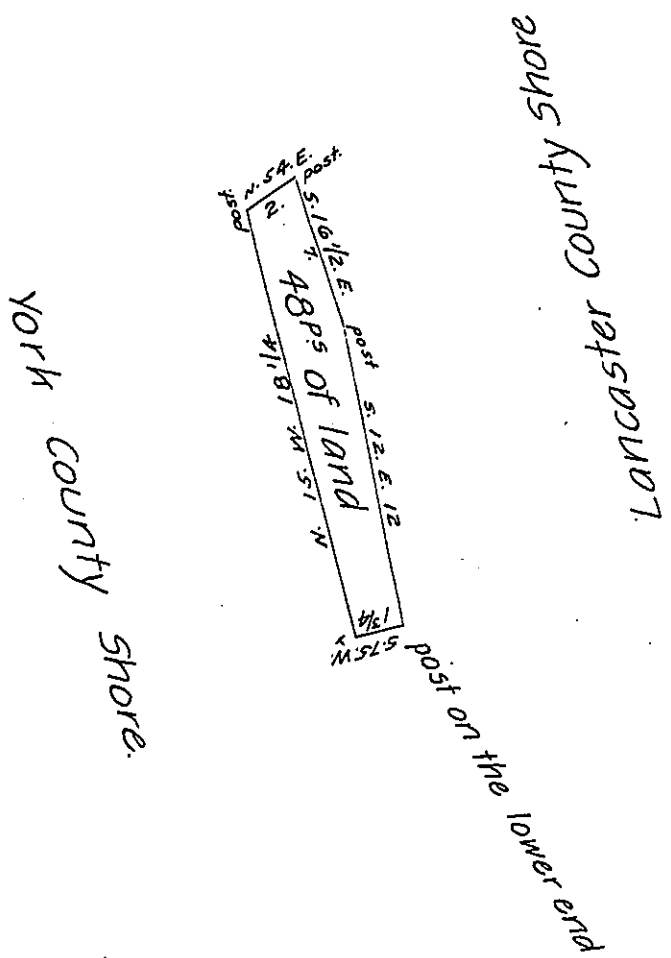

A Draught of an Island Situate in the river Susquehanna, Called Ceder Island, about thirty perches west of Williamsons Island and about forty perches from the Lancaster County Shore, in Little Britian Township in the County of Lancaster. Containing forty eight perches of land. Surveyed the 26th day of November 1803, by Henry Ream ^{then} Deputy Surveyor for Vincent Stubbs by Warrant dated the 7th of November 1803. taken from his field notes. Remaining in my office the 28th of March 1814.

D.S.
 pr. Jacob Hibshman,

To Richard T. Leech, Esq^r. {
 Surveyor General. }

IN TESTIMONY that the above is a copy of the original remaining on file in the Department of Internal Affairs of Pennsylvania, made comformably to an Act of Assembly approved the 16th day of February 1833, I have hereunto set my hand and caused the Seal of said Department to be affixed at Harrisburg, this fourteenth day of January 1907.

Isaac N. Brown
 Secretary of Internal Affairs.